

	0	10	20	30	40	50	60	70	80	90	100	110	120
EXISTING CROWN OF ROAD	3.010	3.042	3.107	3.118	3.209	3.228	3.221	3.239	3.254	3.270	3.308	3.336	3.386
CHAINAGE	0.000	10.000	11.793	12.675	20.000	25.322	30.000	40.000	50.000	60.000	70.000	80.000	100.000
NEW CROWN OF ROAD (NL00)					3.167	3.184	3.194	3.211	3.234	3.254	3.277	3.308	3.340
NEW GUTTER INVERT RIGHT (CF01)			3.029	2.986	3.000	3.012	3.022	3.045	3.069	3.095	3.123	3.151	3.189
NEW GUTTER INVERT LEFT (CF00)			3.031	2.986	3.045	3.056	3.065	3.085	3.105	3.125	3.145	3.165	3.205

LONGITUDINAL SECTION
SCALE: H - 1:200, V - 1:20

SERVICES LEGEND

— T — T —	TELECOMMUNICATIONS
— W — W —	WATER
— G — G —	GAS
— S — S —	SEWER

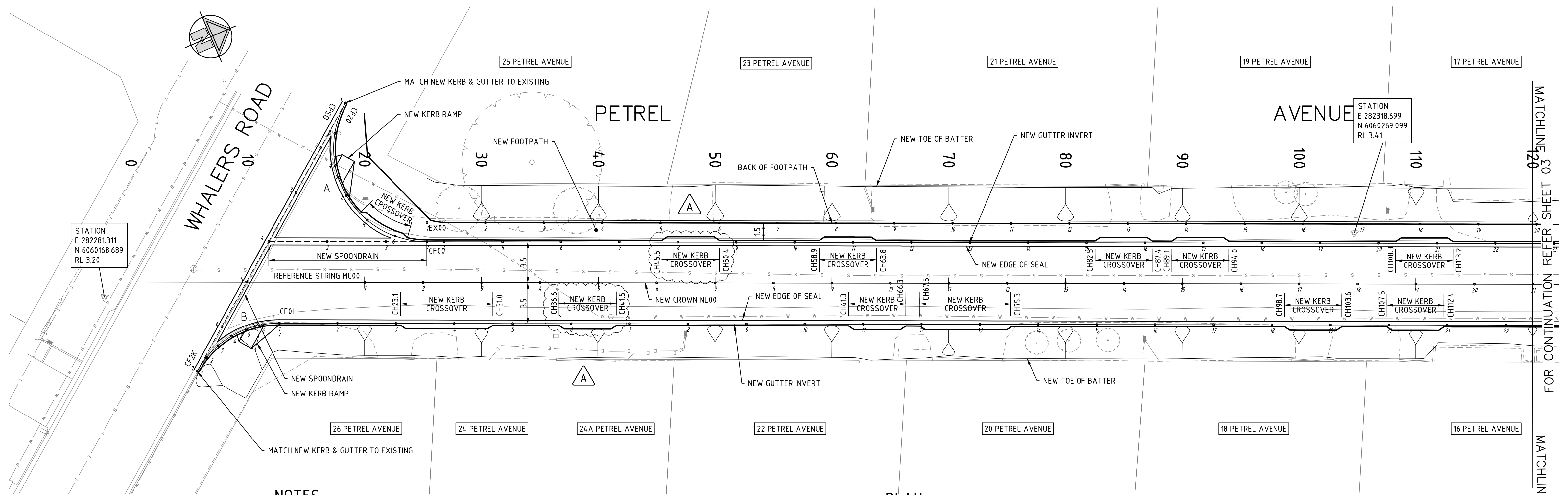

LEGEND

— . . . —	NEW RCP
⊠	NEW DOUBLE SEP
⊞	NEW ACCESSIBLE JUNCTION BOX
⊞	NEW BLIND JUNCTION BOX
— — — —	KERB & GUTTER
— . . . —	SPOONDRAIN

NOTES

- ALL WORKS TO BE PERFORMED IN ACCORDANCE WITH THE SPECIFICATION.
- ALL DIMENSIONS ARE IN METRES UNLESS NOTED OTHERWISE.
- THE CONTRACTOR SHALL CONFIRM ALL DIMENSIONS BEFORE THE COMMENCEMENT OF WORKS.
- SERVICE INFORMATION HAS BEEN PROVIDED BY THE RELEVANT AUTHORITIES. IT IS THE RESPONSIBILITY OF THE CONTRACTOR TO ARRANGE WITH THE RELEVANT SERVICE AUTHORITIES CONFIRMATION OF SERVICES AND THEIR LOCATION BEFORE EXCAVATION WORK COMMENCES.
- COVERS AND FRAMES OF PUBLIC UTILITIES TO BE ADJUSTED TO SUIT NEW WORKS.
- ALL NEW BATTER SLOPES TO BE 1 IN 4 UNLESS STATED OTHERWISE.
- ALL VERGE AREAS TO BE REINSTATED TO EXISTING SURFACE CONDITIONS, GRADED OUT AND MADE GOOD TO THE SATISFACTION OF THE SUPERINTENDENT.
- FOR SETOUT COORDINATES REFER TO SHEET 19.
- FOR STREET LIGHTING DESIGN REFER TO SHEET 20, 21.
- EXERCISE EXTREME CARE WITH EXCAVATING IN ROOT ZONE OF ESTABLISHED TREES. CONTACT COUNCILS GROUP LEADER OPEN SPACE PRIOR TO CUTTING ANY TREE ROOTS OR LIMBS.

PLAN
SCALE: 1:200

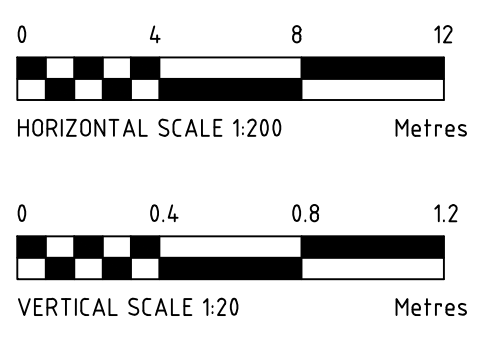

TABLE OF KERB RAMP COORDINATES

CENTRE OF RAMP	EASTING	NORTHING
A	282279.784	6060191.132
B	282288.733	6060179.571

NOTE - EXACT LOCATION OF KERB RAMPS TO BE DETERMINED DURING CONSTRUCTION BY SUPERINTENDENT

WGA
WALLBRIDGE GILBERT AZTEC
60 Wyatt Street, Adelaide, SA 5000
Telephone 08 8223 7433
Email adelaide@wga.com.au

JOB NO	WAD161354-02A.REV-A
DESIGN	M.BERRY
DRAWN	T.BETTERIDGE
CHECKED	P.FLOOD
DIRECTOR	D.BYRNE

FOR CONSTRUCTION

DRAWING SHEET DETAILS				CITY OF VICTOR HARBOR P.O. BOX 11 VICTOR HARBOR S.A. 5211	PROJECT OWNER NAME DATE	COMMENTS RECEIVED				PETREL AVENUE GENERAL CONSTRUCTION PLAN; MC00 CH 0.0 TO 120.0 ENCOUNTER BAY	PLAN No. CW55238 SHEET No. 02 REV CODE A	
ORIGINAL SHEET SIZE	A1	SCALES USED	H 1:200, V 1:20			TITLE	NAME	SIGNATURE	DATE			
COORDINATE SYSTEM	MG494	CAD FILE NAME	WAD161354-02A.DWG	MANAGER INFRASTRUCTURE	BRUCE HENDERSON			MANAGER ENVIRONMENT & RECREATION	BRIAN DOMAN			
REVISIONS & APPROVALS				MANAGER OPERATIONS	MIKE ROSS			PROJECT COORDINATOR	ANTHONY TAYLOR			